

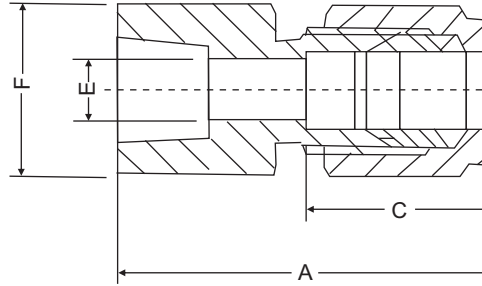

Dimensional Details :

Notes : Drawings are not to scale

Dimensional Details
Dimension, in.

Tube OD	NPT Male Thread Size	Part Number	A	C	E	F
1/8	1/8	S2CFS2N	1.13	0.50	0.09	9/16
1/8	1/4	S2CFS4N	1.32	0.50	0.09	3/4
1/4	1/8	S4CFS2N	1.23	0.60	0.19	9/16
1/4	1/4	S4CFS4N	1.41	0.60	0.19	3/4
1/4	3/8	S4CFS6N	1.48	0.60	0.19	7/8
1/4	1/2	S4CFS8N	1.67	0.60	0.19	1 1/16
3/8	1/4	S6CFS4N	1.48	0.66	0.28	3/4
3/8	3/8	S6CFS6N	1.54	0.66	0.28	7/8
3/8	1/2	S6CFS8N	1.73	0.66	0.28	1 1/16
3/8	3/4	S6CFS12N	1.88	0.66	0.28	1 5/16
1/2	1/4	S8CFS4N	1.59	0.90	0.41	13/16
1/2	3/8	S8CFS6N	1.65	0.90	0.41	7/8
1/2	1/2	S8CFS8N	1.84	0.90	0.41	1 1/16
1/2	3/4	S8CFS12N	1.90	0.90	0.41	1 5/16
3/4	1/2	S12CFS8N	1.84	0.96	0.62	1 1/16
3/4	3/4	S12CFS12N	1.90	0.96	0.62	1 5/16
1	3/4	S16CFS12N	2.10	1.23	0.88	1 3/8
1	1	S16CFS16N	2.45	1.23	0.88	1 5/8

Dimension, mm.

Tube OD	NPT Male Thread Size	Part Number	A	C	E	F
6	1/4	SM6CFS4N	35.8	15.3	4.8	19
6	3/8	SM6CFS6N	37.6	15.3	4.8	22
6	1/2	SM6CFS8N	42.5	15.3	4.8	27
8	1/4	SM8CFS4N	37.0	16.2	6.4	19
8	3/8	SM8CFS6N	38.5	16.2	6.4	22
8	1/2	SM8CFS8N	43.3	16.2	6.4	27
10	1/4	SM10CFS4N	37.8	17.2	7.9	19
10	3/8	SM10CFS6N	39.4	17.2	7.9	22
10	1/2	SM10CFS8N	44.2	17.2	7.9	27
12	1/4	SM12CFS4N	40.3	22.8	9.5	22
12	3/8	SM12CFS6N	41.9	22.8	9.5	22
12	1/2	SM12CFS8N	46.7	22.8	9.5	27
16	1/2	SM16CFS8N	46.9	24.4	12.7	27
20	1/2	SM20CFS8N	47.9	26.0	15.9	30
20	3/4	SM20CFS12N	49.7	26.0	15.9	35
22	3/4	SM22CFS12N	49.7	26.0	18.3	35
22	1	SM22CFS16N	57.9	26.0	18.3	41
25	3/4	SM25CFS12N	53.4	31.3	21.8	35
25	1	SM25CFS16N	62.3	31.3	21.8	41

Dimensions and specifications shown are approximate, may vary from time to time.

Note : 1. A and C dimensions are typical finger-tight
 2. Other Threading available on request

 Note : Specifications and dimensions given in this product catalogue represents the state of engineering at the time of printing .
 Modifications may take place and materials specified may be replaced by others without prior notice.